

Zee Tags

PO Box 1228

Eagle Farm QLD 4009

Telephone: (07) 3216 4828 • Facsimile: (07) 3216 4995

Email: info@zeetaas.com.au



ZEE TAGS ONE PIECE

Application Instructions

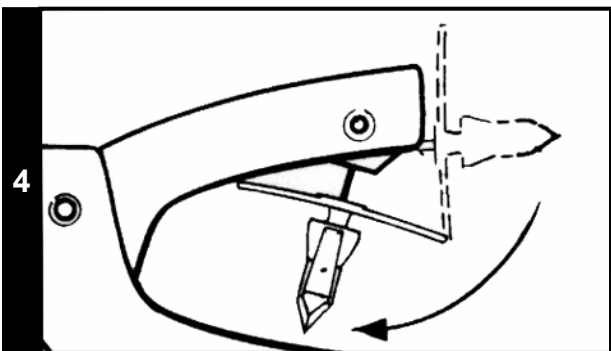
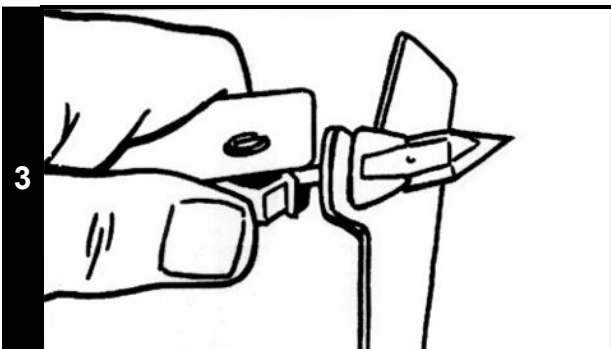
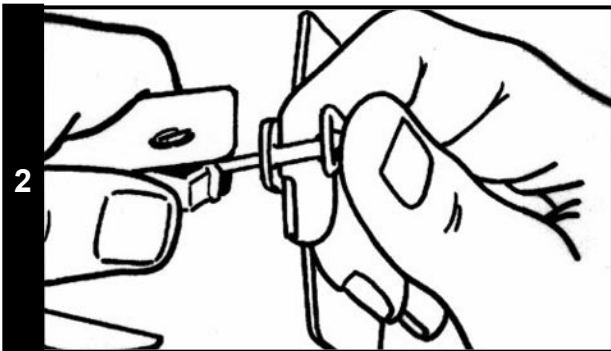
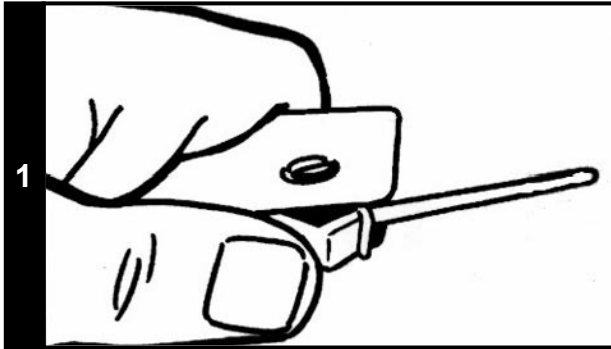

- 1** Flip applicator pin up to tag loading position, then hold as shown.
- 2** Insert the pin into the tag head while holding the tag as shown.
- 3** Straighten head of tag by lifting up with the forefinger and pushing down the thumb, now firmly push the tag completely onto pin.
- 4** Rotate tag to the side, then flip the applicator pin down into tagging position.
- 5** Tag through the front of the ear only. To apply tag, squeeze handles firmly and hold closed.

Please Note:

For animals with soft ears: Young calves, goats and sheep. It is important to grasp tip of ear with a free hand and hold the ear taut to add support and ensure complete penetration of the tag through the ear.

- 6** To remove applicator: **WITHOUT OPENING HANDLES**, pull straight down from the animals ear in one smooth motion. When the Zee Tag Applicator is pulled away from the ear, the pin automatically flips open. This prevents ripped ears and damage to the pin.

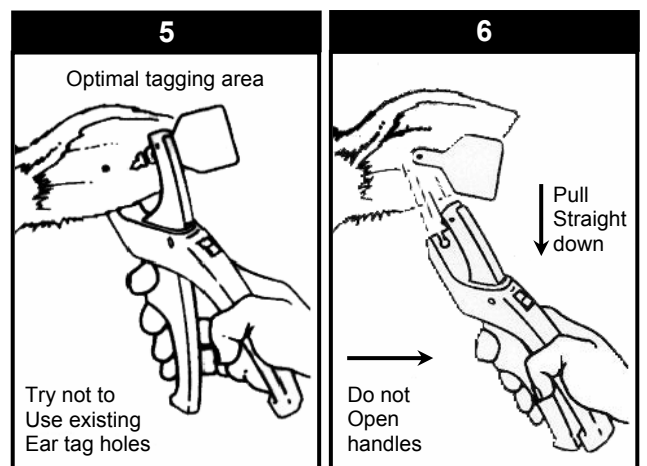

Properly inserted, the One Piece Zee Tag looks like this.

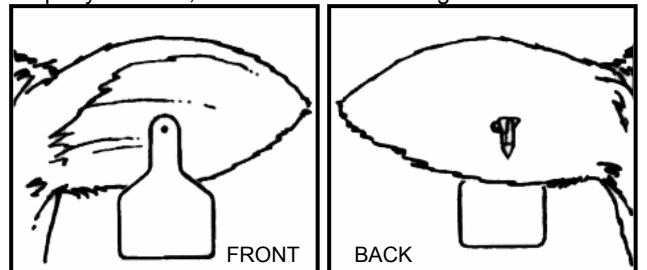

HELPFUL HINTS

Need a spare pin?

- There is one in the bottom handle of the applicator.

Keep your Zee Tag Applicator running smoothly.

- Use a light lubricant or any silicone based product on the applicator pin.

Mark your own numbers to last.

- Use the Zee Tag marking pen, applying two good coats of ink for maximum penetration into the tag and longer lasting numbers.