

## Zee Tags

PO Box 1228

Eagle Farm QLD 4009

Telephone: (07) 3216 4828 • Facsimile: (07) 3216 4995

Email: info@zeetaas.com.au



# ZEE TAGS TWO PIECE

## Application Instructions

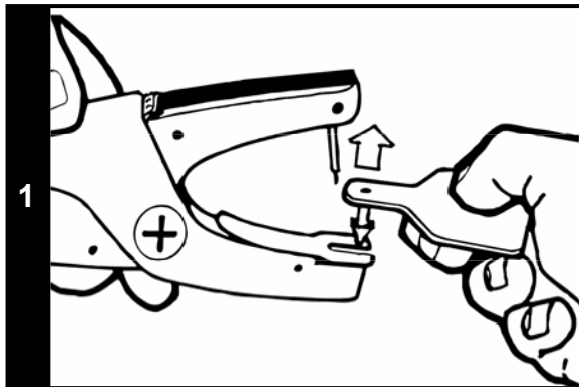

- 1 Push the male tag fully onto the applicator pin.

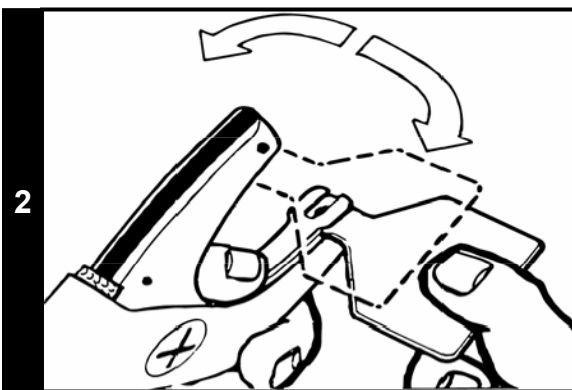

- 2 Depress the end of the female tag clip and place the female tag into position, making sure it is correctly aligned.



- 3 Position the tag between the two main cartilages, approximately halfway between the animal's head and the tip of the ear. Squeeze the applicator handles firmly closed. When the two tags have locked together the top applicator arm will release (the pin may also flip out) and the tag will be removed from the applicator automatically. This prevents ripped ears and damage to the pin. The applicator can then be freely withdrawn from the ear.

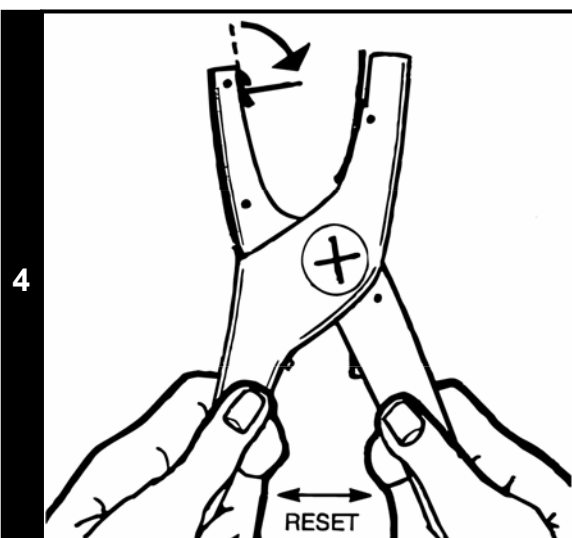

- 4 Reset the applicator and pin if necessary.

### HELPFUL HINTS

*It is recommended that the FEMALE tag always goes in the front of the ear. Thus the MALE tag should be applied from the BACK*

#### **Need a spare pin?**

- There is one in the bottom handle of the applicator.

#### **Keep your Zee Tag Applicator running smoothly.**

- Use a light lubricant or any silicone based product on the applicator pin.